

Attaching and Removing Snap-on Hinges

Locate the lugs on the mounting plate into the recesses beneath the arm.

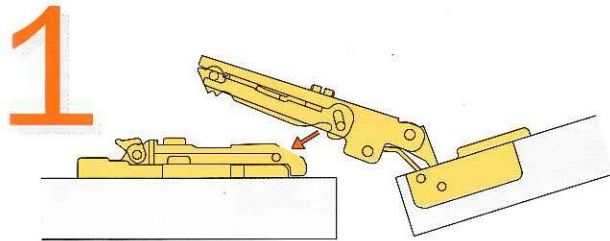

Gently rotate the door in the direction shown.

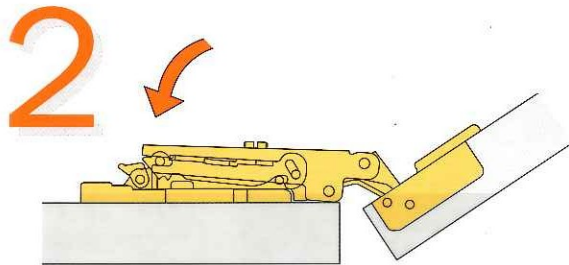

Then press lightly on the end of the arm to secure the catch.

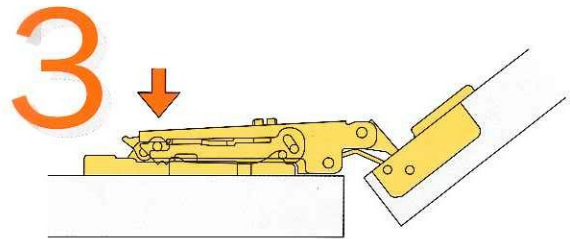

To remove the hinge from the mounting plate, press gently in the places shown by the arrows.

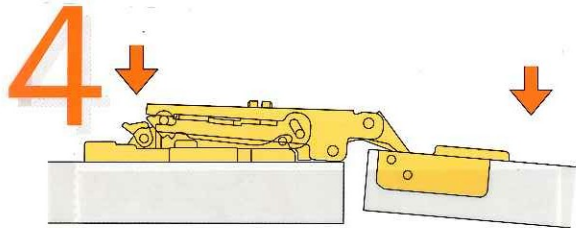

Adjusting the Height of Doors

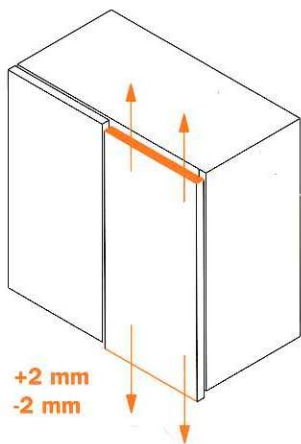

Height adjustment with mounting plates models B2RXE and DOMI® - Snap-on mounting plates, models BAP7P and BARXP

Height adjustment is made without loosening any screws.

The door can be moved vertically ± 2 mm simply by rotating the cam adjuster incorporated in this range of mounting plates.

Height adjustment by cam

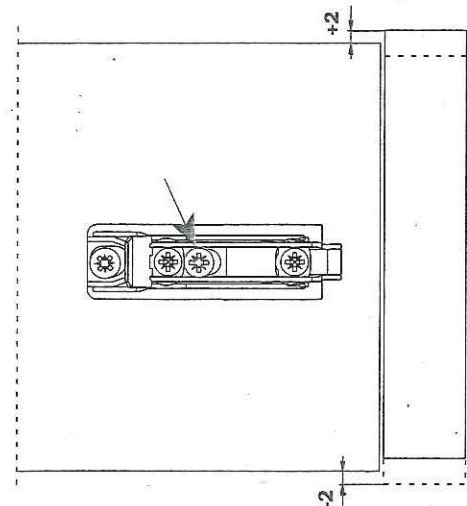
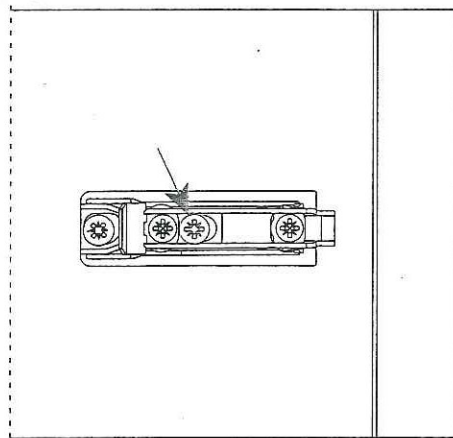

Adjusting the Depth of Doors

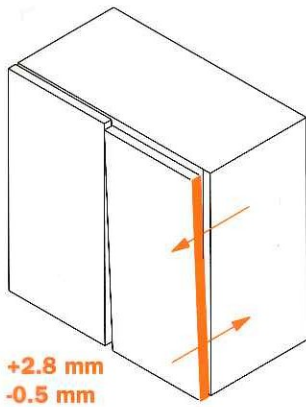

Depth adjustment with DOMI® snap-on mounting plates

Frontal adjustment is made without loosening any screws. The door can be moved frontally from -0.5 to +2.8 mm simply by rotating the cam adjuster in this range of mounting plates.

Depth adjustment by cam

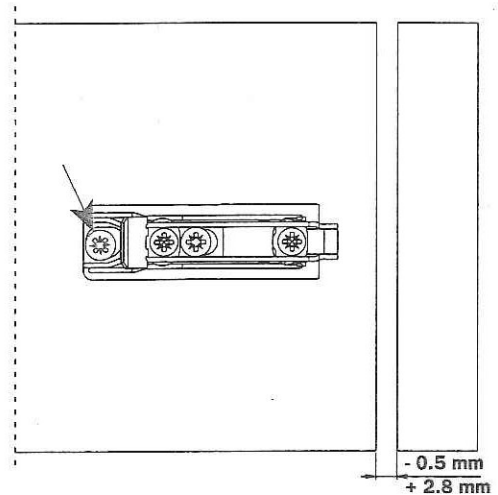
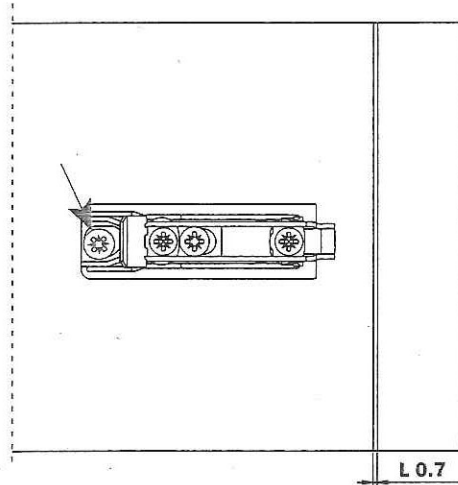

Adjusting the Parallel and Side Alignment of Doors

Side to side adjustment of the door

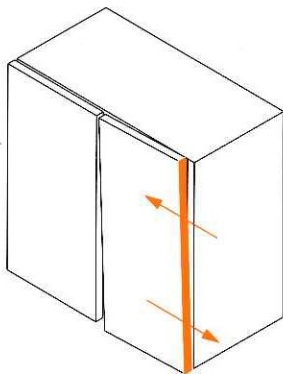

An ingenious adjustment system allows the door to be moved sideways without changing the gap behind the door (the "L" value of 0.7 mm remains constant).

Compensating side adjustment. A patented system exclusive to all Salice 200 and F series hinges.

The adjustment screw operates in conjunction with the inner leaf of the hinge arm.

The door moves in only one direction - parallel to the carcass and without a gap developing between the door and the carcass.

No further adjustments are necessary. There is no gap to reduce.

